

**Series 4, washing machine, front loader, 9 kg, 1200 rpm
WAN24126AU**



Washing machine with Iron Assist to reduce your ironing pile and with a long lasting EcoSilence Drive motor.

- **Active Water Plus:** For highly efficient use of water even with smaller loads thanks to automatic load detection.
- **Reload function:** forgot an item? Add it easily to the wash.
- **Speed Perfect:** perfectly clean in up to 65% less time
- .
- **Iron Assist: reduce wrinkles up to 50%.**
- **Eco Silence Drive™: the efficient and highly durable washing machine drive.**

Maximum capacity in kg :	9.0 kg
Built-in / Free-standing:	Free-standing
Dimensions of the product:	845x598x590 mm
Net weight:	71.2 kg
Connection rating:	2300 W
Fuse protection:	10 A
Voltage:	220-240 V
Frequency:	50 Hz
Length electrical supply cord:	160.0 cm
Door hinge:	Left
Wheels:	No
EAN code:	4242005397754
Installation typology:	Free-standing



- WMZ2200 Floor securing component
 WMZ2381 Extension for cold water inlet /Aquastop
 WMZPW20W Platform with pull-out, washer, cubic

Series 4, washing machine, front loader, 9 kg, 1200 rpm WAN24126AU

Washing machine with Iron Assist to reduce your ironing pile and with a long lasting EcoSilence Drive motor.

Capacity

- Capacity: 9 kg

Consumption rates

- 5 Star Energy Rating
- Energy consumption 210 kWh per year based on Cottons Eco program at 60°C, with 1200 rpm spin speed, seven times per week. When tested in accordance with AS/NZS 2040.2. Actual energy consumption will depend on how the appliance is used.
- 4.5 Star water rating (WELS)
- Water consumption 78 l litres per wash, using the Cottons Eco, 60°C, program at 1200 rpm. In accordance with AS/NZS 6400. Actual water consumption will depend on how the appliance is used. C02277.

Programs

- Standard programs:
 - Cottons: hard-wearing items made from cotton, linen or blended fabrics
 - Cottons + PreWash: for stubborn stains and heavily soiled garments
 - Easy care: items made from synthetic or blended fabrics
 - Delicate/Silk: Delicate, washable items made from Silk, viscose and synthetics
 - Wool: hand or machine washable items that are made from wool or contain wool
- Additional specialty programs:
 - Drum Clean: cleaning and care program for the drum with reminder function
 - Iron Assist - with added steam for wrinkle reduction
 - Shirts/Blouses: non-iron shirts and blouses made from cotton, linen, or blended fabrics
 - Hygiene Plus Easy Care: items made from synthetic or blended fabrics
 - Spin/Drain: spins and drains the water
 - Mixed: lightly soiled items made from cotton, linen or blended fabrics
 - Rinse: rinses and then spins the laundry, and then drains the water
 - Super 15'/30': short program for small lightly soiled items
- Iron Assist: Steam programme that reduces wrinkles on dry clothes

Performance

- Spin speed 400 - 1200 rpm
- SpeedPerfect: perfectly clean in up to 65% less time.
- EcoSilence Drive: quiet, durable, and energy-efficient brushless motor (BLDC) with 10-year motor warranty

Features

- Touch control option settings include:
 - Finish in (delayed start): delay the start of the program by up to 24 hours
 - Rinse Plus: Adds more rinse cycles, suited for highly soiled clothing
 - Start/Pause with Reload function: allows you to add a forgotten garment even after the wash cycle has started
 - Temperature selection: manually adjust the temperature
 - SpeedPerfect: reduce cleaning time by up to 65%
 - Spin Speed: manually adjust the spin speed
 - Reload function to pause machine operation for adding in last minute laundry items
 - ActiveWater Plus: for highly efficient use of water even with small loads thanks to automatic load detection.

- Large display for spin speed, remaining time, 24 h end time delay and load recommendation
- Aqua Protection Plus anti-flood protection with self-sealing hose, minimises the risk of flooding
- AntiVibration Side Panels reduce vibrations and noise levels, making it extremely quiet during the spin cycle
- Foam detection system to remove excessive foam
- Unbalanced load detection
- End of cycle indicator
- Large porthole, silver-black grey with 171° door for easy loading/unloading
- Time delay to select end of time of your wash (1-24 hours) and time remaining indicator

Technical Information

- Slide-under height of 85cm
- Dimensions (H x W x D): 84.5 cm x 59.8 cm x 59.0 cm (63.3 cm including door handle)
- Operating noise level (based on Cotton 60°C program): wash 47 / 72 spin dB(A)

Safety

- Child lock for door and buttons

**Series 4, washing machine, front loader, 9 kg, 1200 rpm
WAN24126AU**

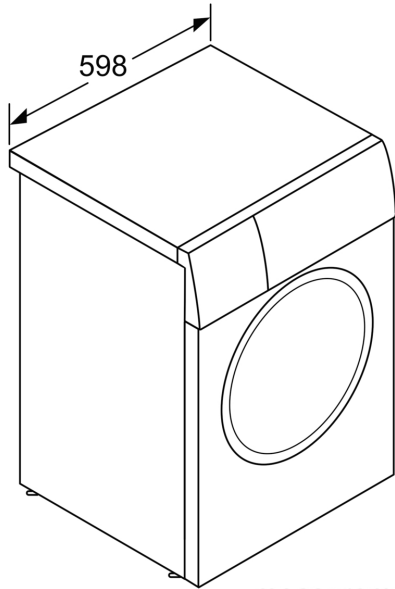

measurements in mm

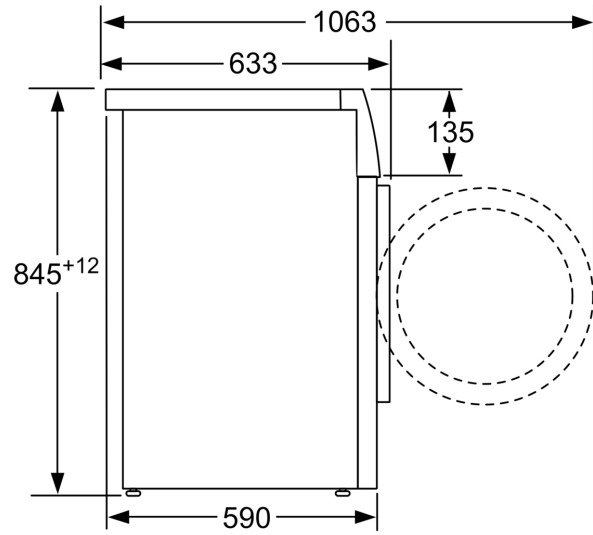

measurements in mm