

Versatile wine cabinet that can be set as a single zone for cellaring both reds and whites or as multi-temp for serving different styles/varietyals at perfect drinking temperatures.

RRP AUS \$4,499.00 AUS \$4,499.00



Product Details

FEATURES

Audio and visual alarm	LED internal lighting	Digital temperature display	Adjustable wooden shelves
Security lock	Double glazed door, with anti-UV glass	Winter function heating system	

BENEFITS

Multi-Temp
 Vintec versatile Multi-Temp technology is designed for serving different varietals at their perfect individual drinking temperatures. It provides a gradient of temperature throughout the cabinet, which is ideal for keeping all wine styles at their optimal drinking temperature.

Winter Heating Function
 In some areas, the temperature in winter could drop drastically. Our wine cabinets are equipped with a heating function to deliver a constant temperature through the cellar all year round.

Stable Temperature
 Our wine cabinets maintain a stable temperature to keep your wine in perfect cellaring conditions. This is thanks to double glazed glass, insulated side panels and interactions between a compressor and thermostat. (Digital display varies by model)

UV Protected Dark Storage Area
 UV rays negatively impact the quality of your wine. Our cabinets eliminate this threat by incorporating UV treated tinted glass doors, dark interiors and dimmed internal LED lights.

No Vibration
 To protect the storage life and quality of your wine, our cabinets have been designed to create a vibration proof environment by including an externally housed compressor, rubber shock absorbers and vibration absorbing wooden shelves.

Specifications

WINE CELLARS

Domestic warranty details (yrs)	2
Installation Type	Both
Finish	Borderless Black Glass
Door Type	Glass Door
Door Construction	Double Glazed, UV Treated
Handle	Recessed
Fridge door opening	Right
Refrigerant	R600a
Easy Capacity (Bottles)	80
Max Capacity (Bottles)	148
Main Function	Serve a Wide Range of Varietals
Alternate Function	Cellar Reds & Whites
No of Zones	1 or Multi

DIMENSIONS

Height (mm)	1550
Width (mm)	595
Depth (mm)	610
Number of rows (Total inc bottom & ½ shelves)	6
Number of columns	1
Max number of slots	6

WINE CELLARS

Temperature Range Zone 1 (deg)	6 - 22 Degrees C
Air space at sides (mm)	30
Air space above cabinet (mm)	50
Joinery cut out dimension- minimum height (mm)	1600
Joinery cut out dimension- minimum width (mm)	615
Joinery cut out dimension- minimum depth (mm)	640
Power Supply	240V / 10AMP
Electricity Consumption (kWh/Day)	1
Ambient Temperature (deg)	5-35
Display Panel	LED Digital Display
Castors and Feet	2 Front Adjustable Feet, 2 Back Castors
Internal Heater	Yes
Lock	Yes
Alarm	Audio & Visual

WINE CELLARS

Lighting	White LED
Number of Shelves	5
Shelving Material	American oak
Shelving Type	3 full, 1 display, 1 3/4
Pack Dimensions Height (mm)	1625
Pack Dimension Width (mm)	636
Pack Dimension Depth (mm)	671
Type	Wine Cabinet
Function	Both

Dimensions

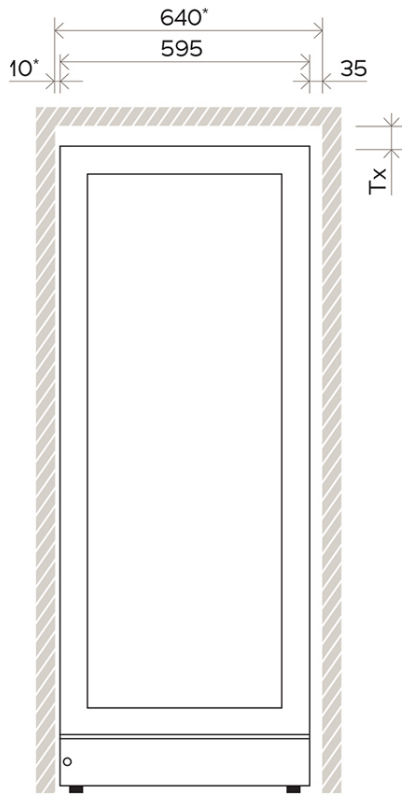

FRONT VIEW

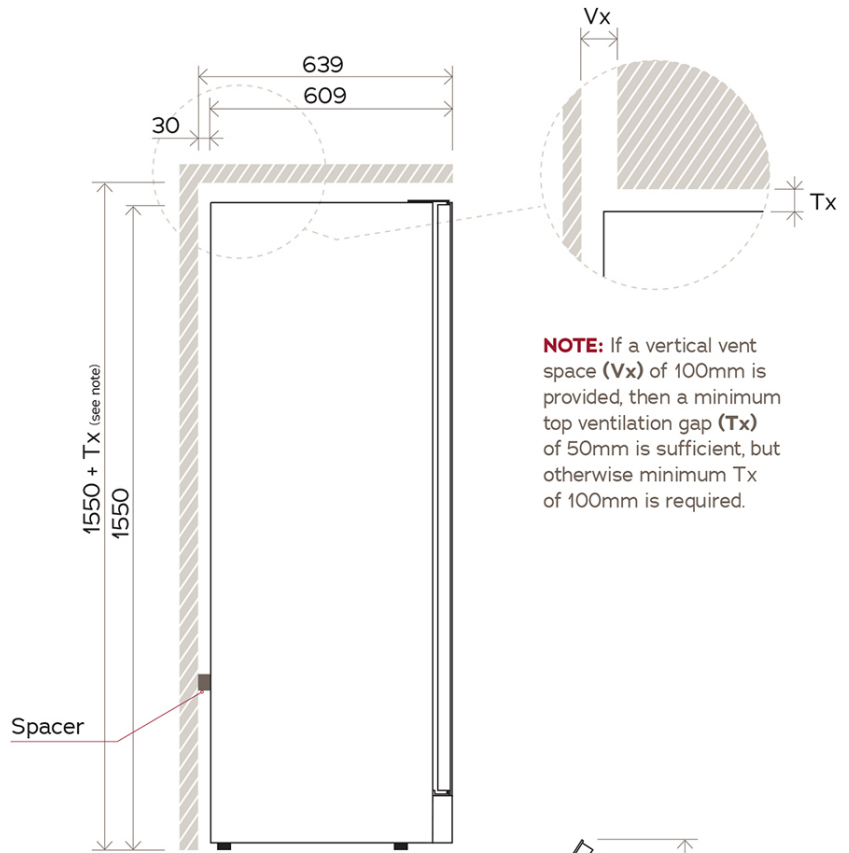

SIDE VIEW

NOTE: If a vertical vent space (**Vx**) of 100mm is provided, then a minimum top ventilation gap (**Tx**) of 50mm is sufficient, but otherwise minimum Tx of 100mm is required.

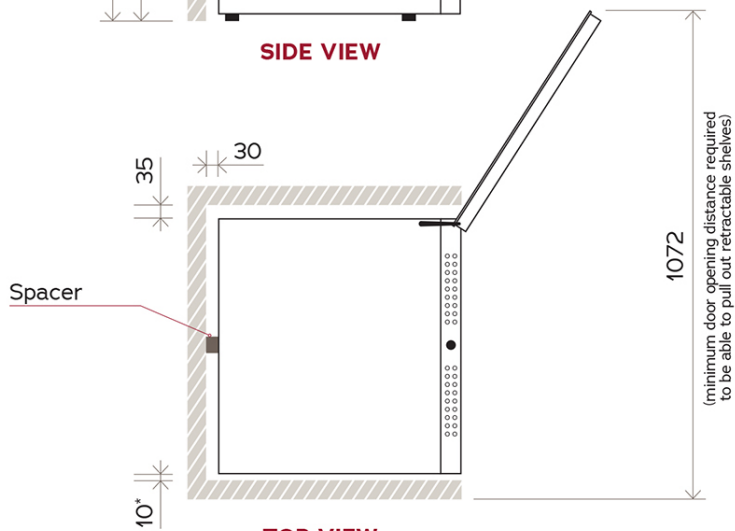

TOP VIEW

NOTE: Illustrations not to scale.
All dimensions in millimetres.

* Minimum 10mm required whether proud-fit or flush-fit, however 30mm is recommended on the opening edge for easy finger grip access when installed flush-fit.

For complete installation instructions, please refer to the user manual for this product.

Terms and Conditions

IMPORTANT

This is a guide of product dimensions only. For complete installation instructions, refer to the manual provided with product.

PRODUCT INFORMATION

The descriptors and illustrations in this publication apply to the specific products and models described as at the date of issue. Under our policy of continuous product development, product specifications may change without notice. Prospective purchasers should therefore check with their retailer to ensure this publication correctly describes the products that are being offered for sale. All information supplied is to be used for general reference purposes only and is on the understanding that Electrolux Home Products Pty Ltd (Australia) and Electrolux (NZ) Ltd (New Zealand) will not be liable for any loss, liability or damage of whatever kind arising as a result of reliance on such information. Colours of products illustrated are as close as printing limitations allow. Electrolux will at all times comply with its obligations pursuant to law including Trade Practices (Australian Consumer Law) Act and Regulations.

WARRANTY

This warranty only applies to Appliances purchased and used in Australia or New Zealand and used in normal domestic applications and is in addition to (and does not exclude, restrict, or modify in any way) any non-excludable statutory warranties in Australia or New Zealand. All warranties are subject to the conditions set out in the warranty card accompanying the product when purchased.

ELECTROLUX HOME PRODUCTS AUSTRALIA

telephone: 1300 363 640

fax: 1800 350 067

email: customercare@electrolux.com.au

web: www.electrolux.com.au

ELECTROLUX HOME PRODUCTS NEW ZEALAND

telephone: 09 573 2230

fax: 09 573 2221

email: customercare@electrolux.co.nz

web: www.electrolux.co.nz