

SUBLINE 700-U LEVEL

Single bowl undermount sink with 2 level configuration

BLANCO

SUBLINE700ULK5 Anthracite



SUBLINE700ULBK5 Black



SUBLINE700ULWK5 White



SUBLINE700ULGK5 Rock Grey

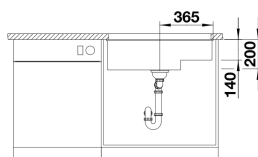
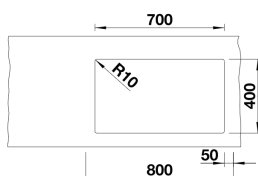
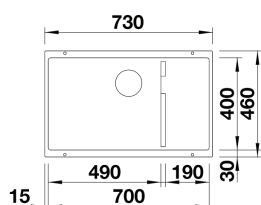

Key Features

Engineered In Germany

Every SILGRANIT™ design impresses with its timeless, straight lined bowl geometry which will suit all types of kitchen products and worktops.

Durability

SILGRANIT™ consist of 80% granite, which makes it unbeatably resilient, extremely durable, scratch resistant, heat resistant, unbreakable and acid resistant.

Hygiene + Plus

A patented formula that acts as a shield against dirt and bacteria growth by an average of 98%.

Maximum bowl size

Due to the smallest possible radii of 10mm, it allows for a large sink area and a modern classy look.

Designer Wastes

No additional costs after purchase.

Rear Waste Position

Increases your storage space below the sink.

Specifications

Method of Installation:

Undermount

Cabinet Size:

80cm cabinet

Overall Dimensions:

730w x 460d x 200/140hmm

Cut-out Dimensions:

700w x 400d (refer to CAD drawing on the website for corner radii)

Main Bowl Capacity:

48 Litres

Standard Inclusion:

Designer Waste

Integrated Overflow:

Yes

Warranty:

30 years

Accessories

Glass Cutting Board

ANDCUTGCB

Plastic Drainer Tray

BDRAINP

Wooden Chopping Board

BWCB

Stainless Steel Outlet Cover

CAPFLOW

Stainless Steel Basket

SUBLINEBK

Stainless Steel Colander

SUBLINECOLSS

Note: Measurements are within 2 - 3mm of factory tolerance. It is advisable to check dimensions of physical product when measuring for installations and before doing any cut outs.
*Due to continual product development the information provided is not final and may be subject to change.