

SUBLINE 500-IF SteelFrame

Single bowl inset/flushmount sink with overflow

BLANCO

SUBLINE500IFK5 Anthracite



SUBLINE500IFBK5 Black



SUBLINE500IFWK5 White

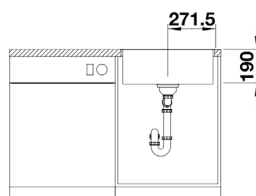
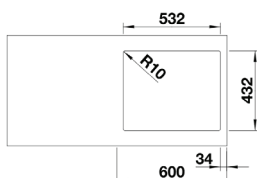
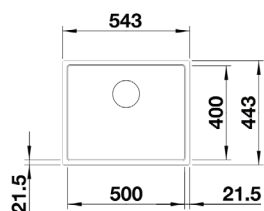

Key Features

Engineered In Germany

Every SILGRANIT™ design impresses with its timeless, straight lined bowl geometry which will suit all types of kitchen products and worktops.

Durability

SILGRANIT™ consist of 80% granite, which makes it unbeatably resilient, extremely durable, scratch resistant, heat resistant, unbreakable and acid resistant.

Hygiene + Plus

A patented formula that acts as a shield against dirt and bacteria growth by an average of 98%.

Maximum bowl size

Due to the smallest possible radii of 10mm, it allows for a large sink area and a modern classy look.

Designer Wastes

No additional costs after purchase.

Rear Waste Position

Increase your storage space below the sink.

Specifications

Method of Installation:

Inset flushmount with IF flat rim

Cabinet Size:

60cm cabinet

Overall Dimensions:

543w x 443d x 190hmm

Inset Cut-out Dimensions:

532w x 432d (refer to CAD drawing on the website for corner radii)

Inset Flushmount Cut-out Dimensions:

545w x 445d (refer to CAD drawing on the website for corner radii)

Bowl Capacity:

36 Litres

Standard Inclusion:

Designer Waste

Integrated Overflow:

Yes

Warranty:

30 years

Accessories

Glass Cutting Board

ANDCUTGCB

Plastic Drainer Tray

BDRAINP

Wooden Chopping Board

BWCB

Stainless Steel Outlet Cover

CAPFLOW

Stainless Steel Floating Grid

FLOATGSS

Stainless Steel Basket

SUBLINEBK

Stainless Steel Colander

SUBLINECOLSS

Note: Measurements are within 2 - 3mm of factory tolerance. It is advisable to check dimensions of physical product when measuring for installations and before doing any cut outs.
*Due to continual product development the information provided is not final and may be subject to change.