

SAI3963B 90CM INDUCTION COOKTOP

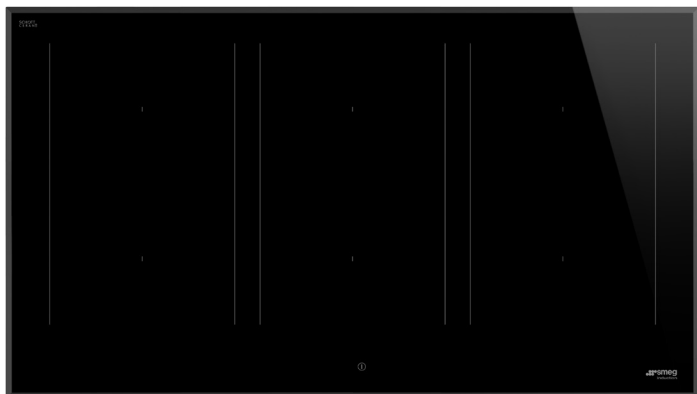

TOUCH CONTROLS

For precise cooking control, each zone is operated by an ergonomic slide control where you can choose to touch directly or finger swipe up and down the 1 to 9 power levels with no 'tapping' required.

BOOST FUNCTION

Boost provides an additional surge of power for even more intense heat and is ideal for heating large quantities of water rapidly.

TIMER FUNCTION

The timer function can be used as an independent minute minder or as a switch off timer for all zones each zone to ensure economical power usage. Timer can be set between 1 minute - 9 hours 59 minutes.

RESIDUAL HEAT INDICATOR

If the induction cooktop surface is still hot a [H] is indicated on the control panel. Once the temperature falls to a safe level the indicator will go out and the cooktop can be easily cleaned.

EAN 8017709288532

Dimensions	900mmW x 53mmH x 510mmD
Finish	Black ceramic
Installation	Topmount
Cutout	880mmW x 490mmD
Capacity	6 zone Front left: 210 x 190 mm, 2100W - boost 3000W Rear left: 210 x 190 mm, 2100W - boost 3000W Rear centre: 210 x 190 mm, 2100W - boost 3000W Front centre: 210 x 190 mm, 2100W - boost 3000W Rear right: 210 x 190 mm, 2100W - boost 3000W Front right: 210 x 190 mm, 2100W - boost 3000W Multizone left: 385 x 230 mm, boost 3700W Multizone centre: 385 x 230 mm, boost 3700W Multizone right: 385 x 230 mm, boost 3700W
Timer	End of cooking acoustic alarm Residual time indicator
Ignition	Automatic electronic
Controls	Slider control
Safety	Pan detection Automatic cut-off Residual heat indicator Control lock Child safety
Power	220 - 240V 50/60Hz 49Amp Connection
Pan size	Automatic pan size recognition
Warranty	Two years parts and labour



ID191217

SAI3963B

90CM INDUCTION COOKTOP

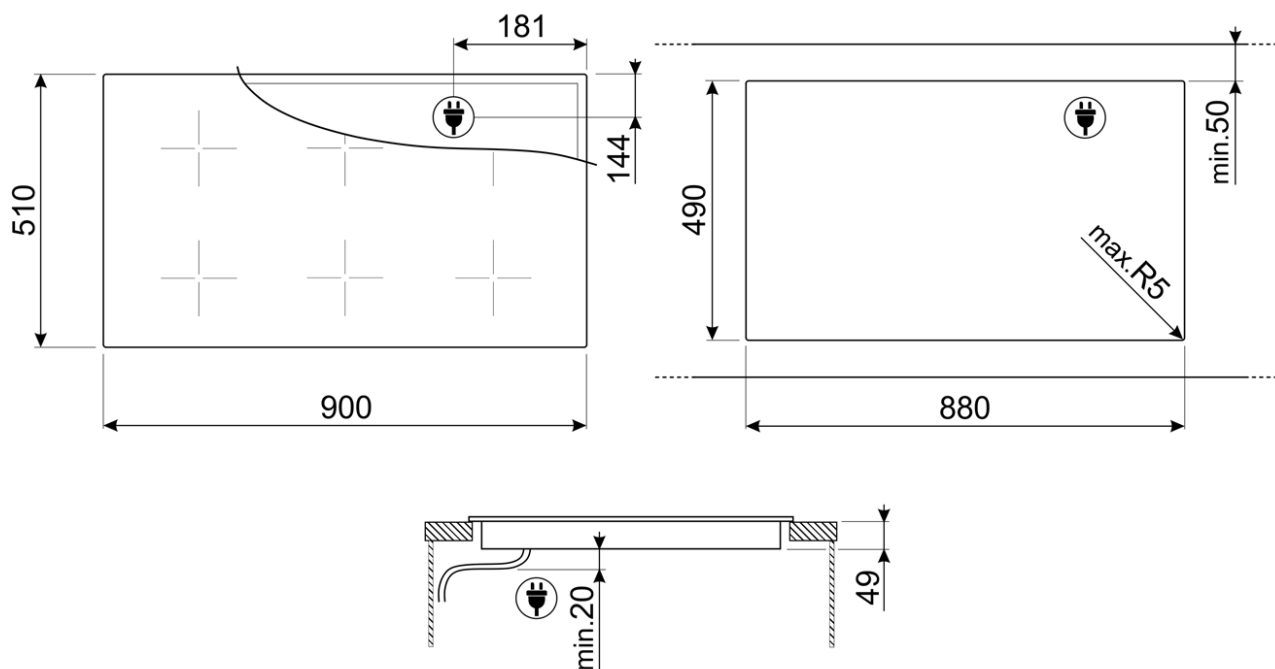

PLEASE NOTE: drawings are not to scale. They are to assist only.
WARNING: technical specifications and product sizes can be varied by the manufacturer without notice.
Cutouts for appliances should only be by physical product measurements. The above information is indicative only.

ID191217