

# AND400/400IFNK5

## Stainless Steel Single Bowl Inset / Flushmount Sink



**BLANCO**



### Model Code

AND400/400IFNK5

### Description

Double bowl inset or flushmount with overflow

### Warranty

30 Year Warranty

## Specifications

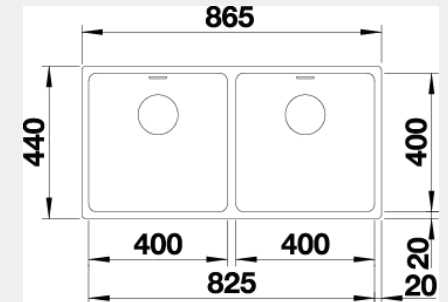
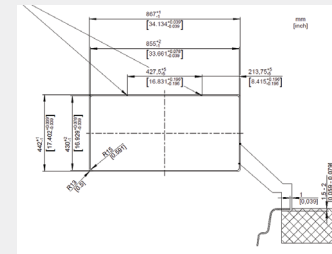

### Features

### Benefits

#### Engineered in Germany

Over 90 years of Stainless Steel know-how make Blanco one of the world leaders in sink manufacturing, which translates to superior products for your home.

#### Inset flushmount installation

This elegant IF flat rim not only has an appealing flush fit but it makes it much easier to clean around the sink.

#### 18/10 Surgical Grade Stainless Steel

Engineered from surgical grade stainless steel and with Blanco's satin finish, this sink is the ultimate food preparation area.

#### Large 53L capacity main bowl

Accommodates the largest of baking trays, woks and other bulky kitchen utensils.

#### Tight radius corners

The small radius maximises useable space in the bowl to allow for larger pots and pans. Also allows for easy cleaning.

#### Broad range offering

Varying sizes available. You can create a design utilising just one bowl or a collection of bowls from the range.

#### Integrated overflow – Plumbing kit supplied

No overfilling of the main bowl, prevents damage to the kitchen.

#### Method of Installation:

Inset/flushmount

#### Cabinet Size:

90cm

#### Overall Dimensions:

865w x 440d x 190h mm

#### Inset Cut-out:

855w x 430d mm  
(refer to CAD drawing on the website for corner radii)

#### Flushmount Cut-out:

867w x 442d mm  
(refer to CAD drawing on the website for corner radii)

#### Bowl Capacity:

30 Litres

#### Standard Inclusion:

Designer Wastes and Integrated Overflow

#### Optional Accessories:

ANDCUTGCB, BDRAINP, ANDDRAINSS,  
BUCRBSS, ANDCOLSS, BWCB, CAPFLOW

#### Warranty:

30 years

#### Mounting hole:

Ø35 mm tap hole required

Note: Measurements are within 2-3mm of factory tolerance. It is advisable to check dimensions of physical product when measuring for installations and before doing any cut outs.

\*Due to continual product development the information provided is not final and may be subject to change.