

# ADON XL 6 S

Single bowl inset with drainer and overflow

# BLANCO

ADONXL6SK5 Anthracite



ADONXL6SBK5 Black



ADONXL6SCK5 Concrete



ADONXL6SWK5 White

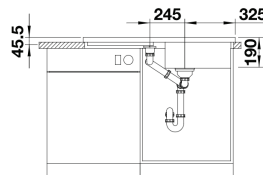
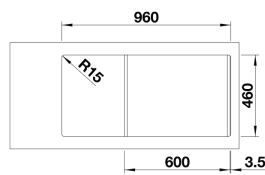
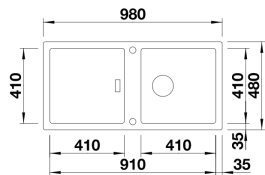

## Key Features

### Engineered In Germany

Every SILGRANIT™ design impresses with its timeless, straight lined bowl geometry which will suit all types of kitchen products and worktops.

### Durability

SILGRANIT™ consist of 80% granite, which makes it unbeatably resilient, extremely durable, scratch resistant, heat resistant, unbreakable and acid resistant.

### Hygiene + Plus

A patented formula that acts as a shield against dirt and bacteria growth by an average of 98%.

### Maximum Bowl Size

Due to the smallest possible radii of 15mm it allows for a large sink area and a modern classy look.

### Designer Wastes

No additional costs after purchase.

### Raised Tap Landing

Further elevates tap from water and helps prevent grime build up at the base of tap.

## Specifications

### Method of Installation:

Inset

### Cabinet Size:

60cm cabinet

### Overall Dimensions:

980w x 480d x 45.5/190hmm

### Cut-out Dimensions:

960w x 460d (refer to CAD drawing on the website for corner radii)

### Main Bowl Capacity:

32 Litres

### Standard Inclusion:

Designer Wastes and overflow

### Integrated Overflow:

Yes

### Warranty:

30 years

## Accessories

### Stainless Steel Basket

SUBLINEBK

Note: Measurements are within 2 - 3mm of factory tolerance. It is advisable to check dimensions of physical product when measuring for installations and before doing any cut outs. \*Due to continual product development the information provided is not final and may be subject to change.