

## H 7840 BMX

Handleless speed oven  
with a seamless design, Automatic programmes and food probe



- Large touch display with movement sensor – M Touch + MotionReact
- Easy cleaning – compartment with PerfectClean and linen structure
- Faster and more consistent results – Quick & Gentle
- Network-enabled WiFi appliance – Miele@home
- Get what you want in 1 easy step – Quick MW and Popcorn button

| Model and design                    |                 |
|-------------------------------------|-----------------|
| Built-in microwave combination oven | •               |
| ArtLine                             | •               |
| Handleless                          | •               |
| Appliance colour                    | Brilliant white |
| Convenience features                |                 |
| Quick & Gentle                      | •               |
| Rapid heat-up                       | •               |
| Food probe                          | With cable      |
| Keeping warm                        | •               |
| Crisp function                      | •               |
| Operating modes                     |                 |
| Defrosting                          | •               |
| Automatic programmes                | •               |
| Automatic programmes                | •               |
| Auto roast                          | •               |
| Grill operating modes               | •               |
| Grill                               | •               |
| Fan plus                            | •               |
| Intensive bake                      | •               |
| Low temperature cooking             | •               |
| Microwave                           | •               |
| Microwave + Auto roast              | •               |
| Microwave + Grill                   | •               |
| Microwave + Fan plus                | •               |
| Microwave + Fan grill               | •               |
| Conventional heat                   | •               |
| Bottom heat                         | •               |
| Fan grill                           | •               |
| Special applications                | •               |

H 7840 BMX

Handleless speed oven  
with a seamless design, Automatic programmes and food probe



| <b>User convenience</b>   |         |
|---|---------|
| Networking with Miele@home  | •       |
| Display   | M Touch |
| MotionReact: light comes on when movement is detected                 | •       |
| MotionReact: display comes on when movement is detected               | •       |
| MotionReact: audible signal is acknowledged when movement is detected | •       |
| MotionReact: detection of cabinet fronts                              | •       |
| Touch2Open  | •       |
| MultiLingua   | •       |
| MyMiele   | •       |
| Help function   | •       |
| Popcorn function  | •       |
| Polyphonic buzzers  | •       |
| Timer functions   | •       |
| Time of day display   | •       |
| Date display  | •       |
| Minute minder   | •       |
| Programmable start of cooking duration                                | •       |
| Programmable end of cooking duration                                  | •       |
| Actual temperature display  | •       |
| Target temperature display  | •       |
| Audible signal when target temperature is reached                     | •       |
| Recommended temperature   | •       |
| Quick microwave   | •       |
| Individual settings   | •       |
| <b>Efficiency and sustainability</b>                                  |         |
| Residual heat utilisation   | •       |
| <b>Cleaning convenience</b>   |         |
| Stainless-steel oven compartment with linen-weave pattern             | •       |
| PerfectClean finish   | •       |
| Hinged grill heater element   | •       |
| CleanGlass door   | •       |
| <b>Safety</b>   |         |
| Appliance cooling system and touch-cool fronts                        | •       |
| Safety switch-off   | •       |
| System lock   | •       |
| Sensor lock   | •       |

H 7840 BMX

Handleless speed oven  
with a seamless design, Automatic programmes and food probe



| <b>Technical data</b>                      |                             |
|--|-----------------------------|
| Oven compartment volume in l               | 43                          |
| No. of shelf levels                        | 3                           |
| Oven light                                 | 1 LED spot                  |
| Temperatures in °C                         | 30                          |
| Microwave power levels in W                | 80/150/300/450/600/850/1000 |
| Appliance width in mm                      | 595                         |
| Appliance height in mm                     | 456                         |
| Appliance depth in mm                      | 568                         |
| Weight in kg                               | 38.0                        |
| Total rated load in kW                     | 3.2                         |
| Voltage in V                               | 220-240                     |
| Number of phases                           | 1                           |
| Fuse rating in A                           | 16                          |
| Length of supply lead in m                 | 2                           |
| <b>Standard accessories</b>                |                             |
| Baking and roasting rack with PerfectClean | 1                           |
| Glass tray                                 | 2                           |

## H 7840 BMX

Handleless speed oven  
with a seamless design, Automatic programmes and food probe

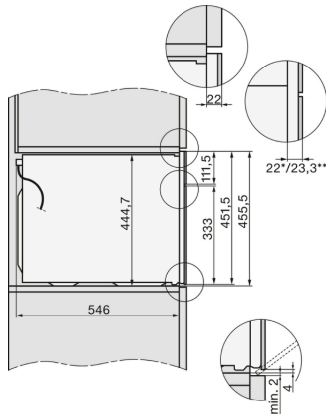

H7x40BM/BMX, installation drawings

22 mm - glass  
23,3 mm - metal

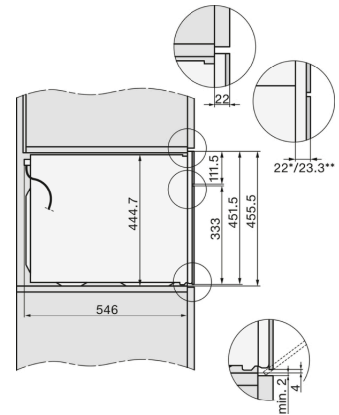

H7x40BM/BMX, installation drawings, GB, AUS

22 mm - glass  
23.3 mm - metal

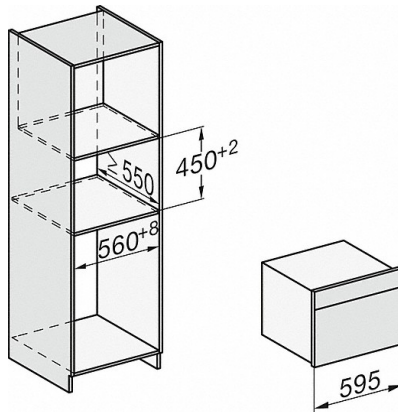

H7x40BM/BMX, installation drawings

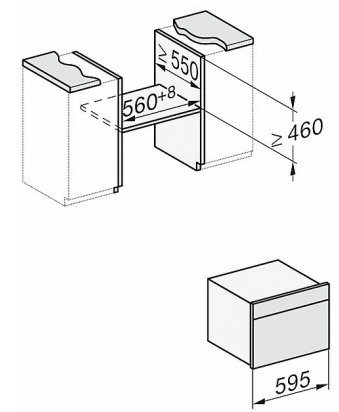

H7x4xBM, installation drawings

If the oven is to be installed under a hob, follow the instructions for installing the hob and the height of the hob.

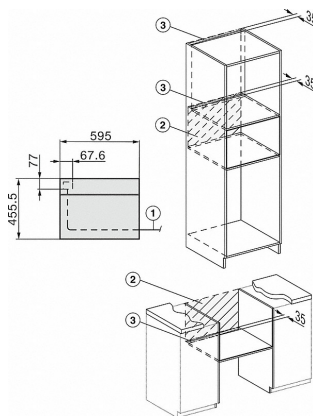

H7x40BM/BMX, installation drawings, GB, AUS

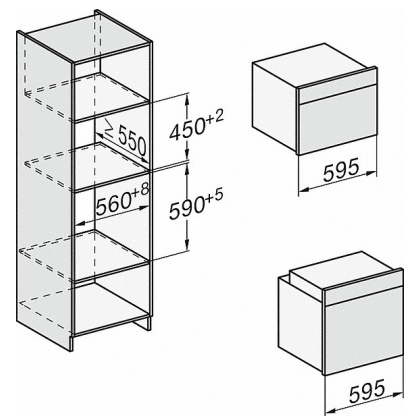

H226x-1B/BP/E/EP/IP, H2760B/BP, H28x0B/BP, H7x40BM/BMX, H7x6xB/BP/BPX, installation drawings

## H 7840 BMX

Handleless speed oven  
with a seamless design, Automatic programmes and food probe

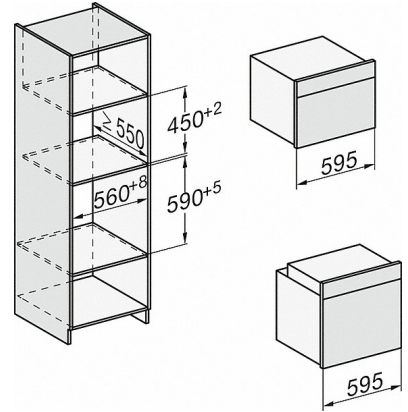
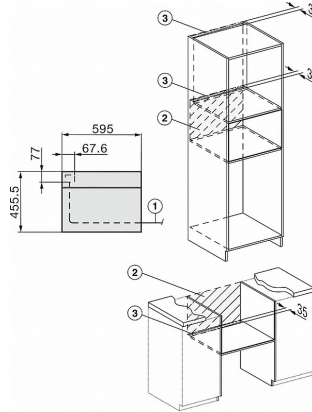

- 1) Mains connection cable, L=2000 mm
- 2) No connection in this area
- 3) Lüftungsausschnitt min. 150 cm<sup>2</sup>

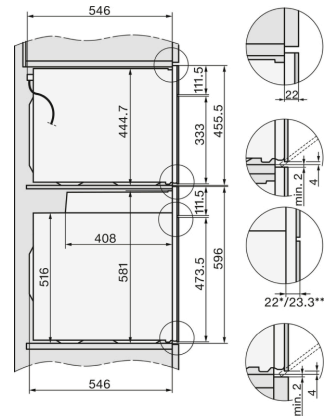
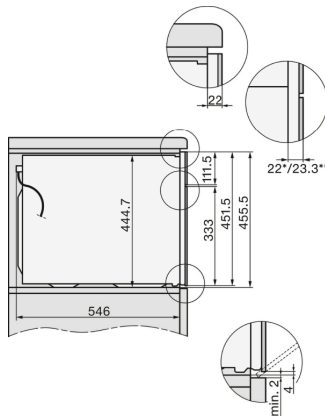

H7x40BM/BMX, installation drawings, GB, AUS

22 mm - glass  
23.3 mm - metal

H2xxx-1 B/BP/E/I/IP, H7xxx B/BP/BM/BMX, installation drawings

22 mm - glass  
23,3 mm - metal

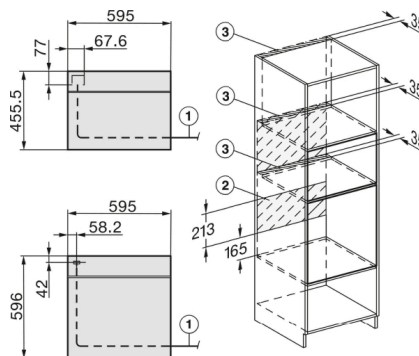

H2xxx-1 B/BP/E/I/IP, H7xxx B/BP/BM/BMX, installation drawings

H 7840 BMX

Handleless speed oven  
with a seamless design, Automatic programmes and food probe

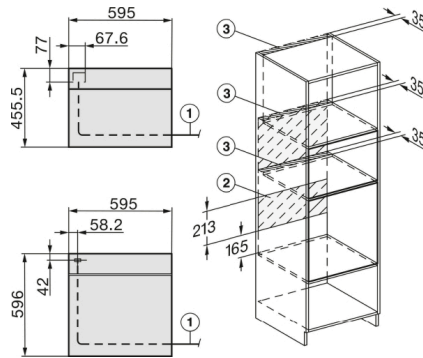

22 mm - glass  
23,3 mm - metal